

LAKE PONTCHARTRAIN

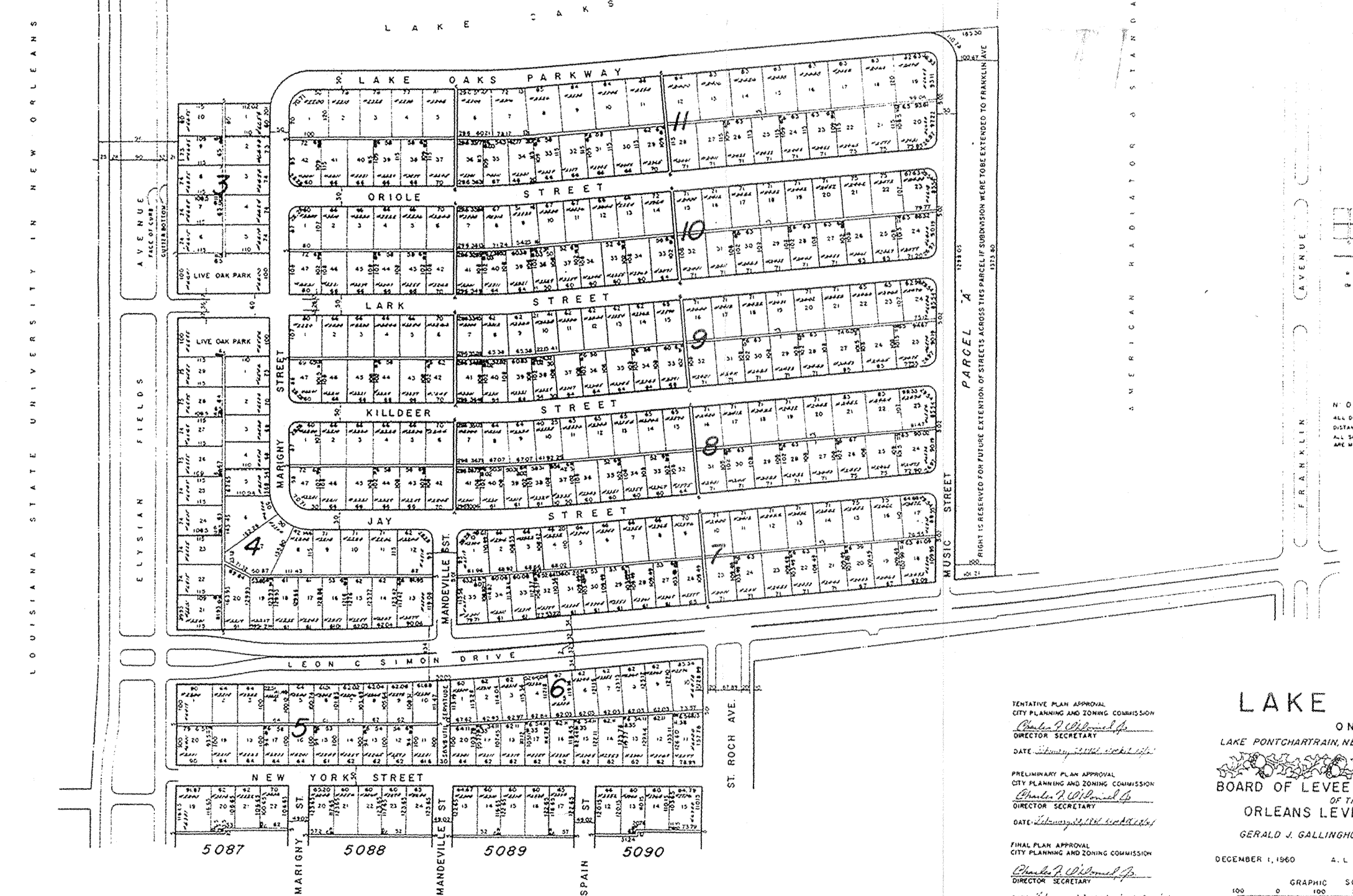
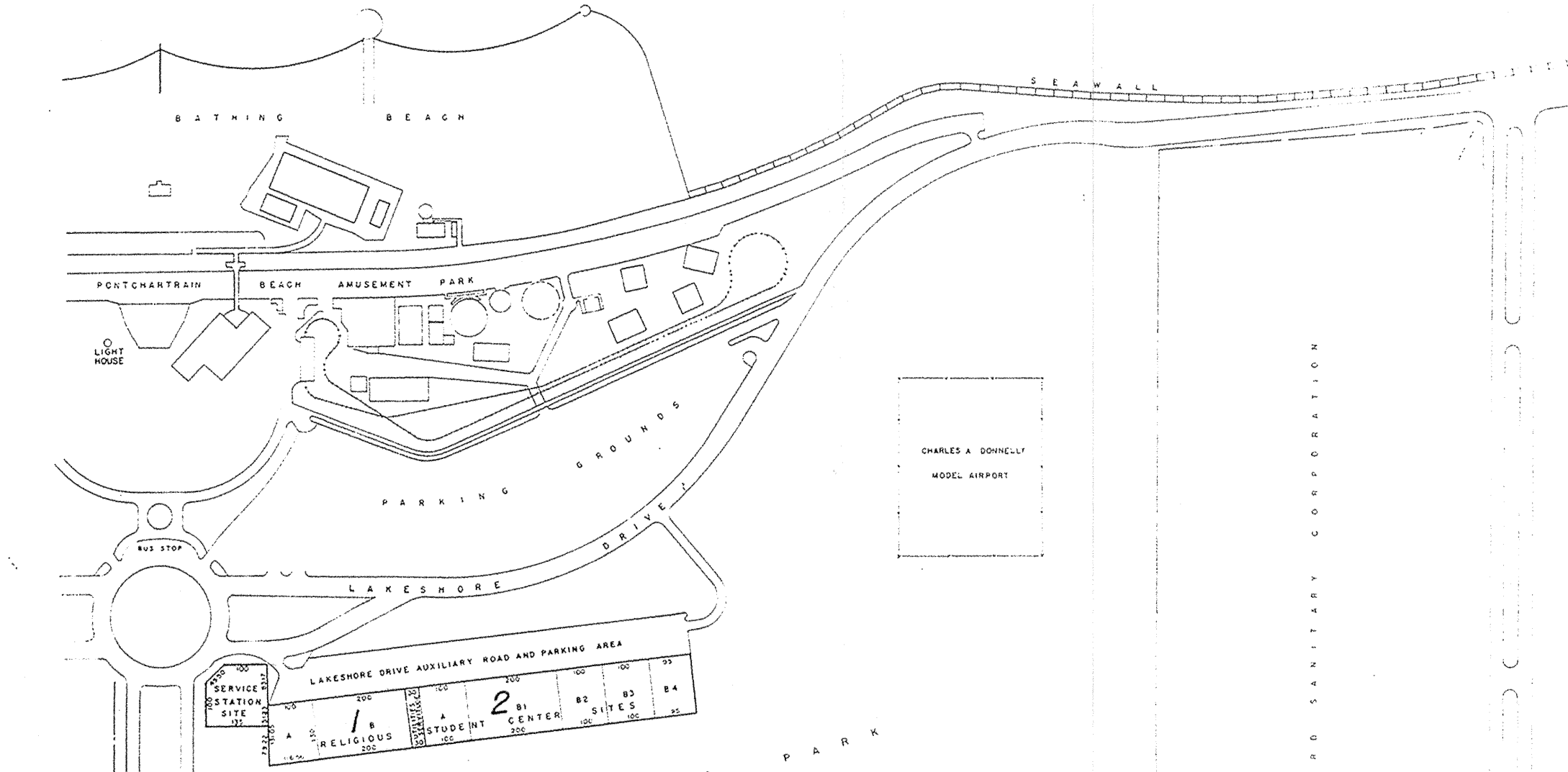

LOUISIANA STATE UNIVERSITY IN NEW ORLEANS

- LEGEND
- 12" DRAINAGE FOR ELECTRIC AND TELEPHONE DISTRIBUTION SYSTEM
 - 12" WATER MAIN
 - 12" GAS MAIN
 - 12" SEWER MAIN
 - 12" CEMENT CONCRETE UNDERGROUND WATER SUPPLY MAIN
 - 12" TRANSFORMER
 - 12" WATER TOWER

NOTE:

ALL DIMENSIONS ALONG CURVES ARE GIVEN AS CHORD DISTANCES UNLESS OTHERWISE NOTED. THE PROPERTY LINE IS ALONG THE ARC AND ALL SQUARE CORNERS ARE 90 DEGREE ANGLES UNLESS OTHERWISE NOTED.

INITIATIVE PLAN APPROVAL
 CITY PLANNING AND ZONING COMMISSION
 DATE 12/1/56

PRELIMINARY PLAN APPROVAL
 CITY PLANNING AND ZONING COMMISSION
 DATE 12/1/56

FINAL PLAN APPROVAL
 CITY PLANNING AND ZONING COMMISSION
 DATE 12/1/56

LAKE OAKS
 ON
 LAKE PONTCHARTRAIN, NEW ORLEANS, LOUISIANA

BOARD OF LEVEE COMMISSIONERS
 OF THE
ORLEANS LEVEE DISTRICT
 GERALD J. GALLINGHOUSE, PRESIDENT

DECEMBER 1, 1960
 A. L. WILCOX, CHIEF ENGINEER

GRAPHIC SCALE
 0 100 200 300 400